

DisplayPort Female

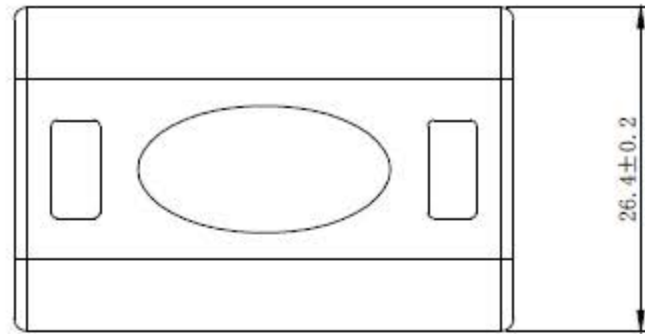

26.4±0.2

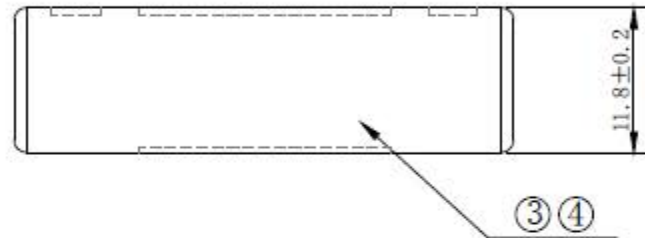

11.8±0.2

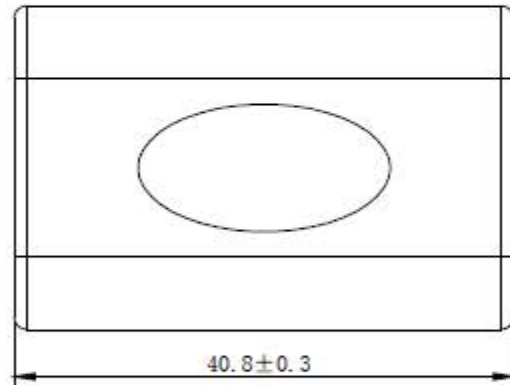

40.8±0.3

DisplayPort Female

CN2

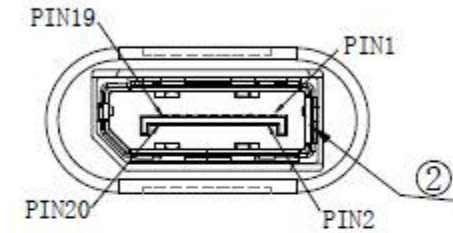

PIN OUT

CN1	CN2	CN1	CN2
01	12	11	02
02	11	12	01
03	10	13	13
04	09	14	14
05	08	15	15
06	07	16	16
07	06	17	17
08	05	18	18
09	04	19	19
10	03	20	20

SHELL — SHELL

NOTE:

- Electrical test:
 - 100% open short & miss wire test;
 - Insulation resistance:DC 300V 0.01s 10M ohm min;
 - Contact resistance:5 ohm max;
- Output:3840*2160P @60Hz
- ROHS 2.0 AND REACH COMPLIANT

MATERIAL LIST:

④	Moulding	PVC Moulding Black	1	
③	PCB	DP to DP PCB	1	
②	Connector	Display port Female,Black insulation The Pin Gold Plating, the Shell For Nickel plating	1	
①	Connector	Display port Female,Black insulation The Pin Gold Plating, the Shell For Nickel plating	1	

NO.	PARTS NAME	SPECIFICATION STANDARD	QT' Y	REMARK
unit	mm			
		NEW		2019-06-17
BY	CHK	REVISION RECORD MODIFICATIONS		DATE
				REV.

ITEM NO.	12.99.3165
Colour	black
DESC.	VALUE DisplayPort (v1.2) Coupler, DP-DP, F/F, 4K @60Hz

SECOMP