

USB 3.0 A Male

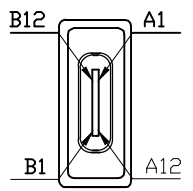

USB Type C Female

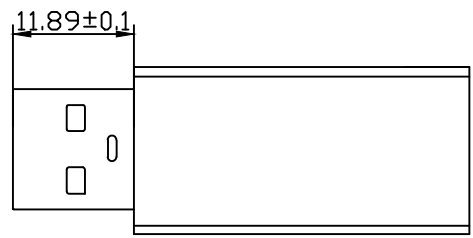
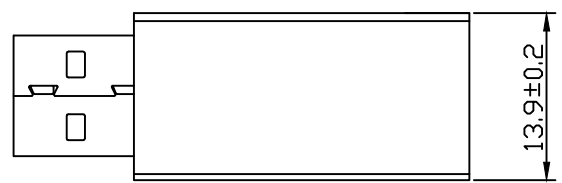

PIN OUT

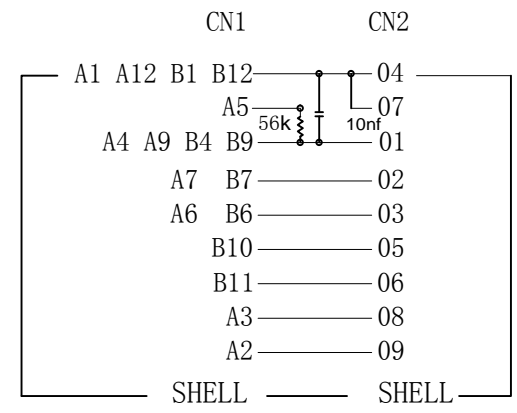

MATERIAL LIST:

③	Housing	Aluminium Shell Black	1	
②	Connector	USB 3.0 A male, Blue insulation The Pin Gold Plating, the Shell For Nickel plating	1	
①	Connector	USB Type C Female, Black insulation The Pin Gold Plating, the Shell For Nickel plating	1	
NO.	PARTS NAME	SPECIFICATION STANDARD	QT' Y	REMARK
BY	CHK	REVISION RECORD MODIFICATIONS	DATE	REV.

NOTES:

- Electrical test:
 - 100% open short & miss wire test;
 - Insulation resistance: DC 300V 10MΩ Min;
 - Contact resistance: 3Ω Max;
- USB 3.2 GEN1 Type C Female Output, USB 3.0 A male input
 Data Transfer: 5Gbps Voltages: 5V Current: 900mA
 RoHS 2.0 and REACH Compliant

Item No. :	12. 99. 2998
DESC.	VALUE USB 3.2 Adapter, A-C, M/F, black

